

# Cast Resin Three Phase Transformers

## Specifications

- Standard : According to EN61558-
- Open construction, degree of protection IP00-; Enclosure type, degree of protection IP44-, IP23-, IP55- etc..
- Winding : Enameled copper wire Class F, B, H Galvanically isolated
- Temperature class insulating materials : B
- Insulation class : F, Max. ambient temperature : 25°C to 50°C
- Electrical protection class : I, Max. temperature rise : 95°C
- Frequency : 50Hz, 60Hz, 60/50Hz
- Type : Cast Resin
- Terminals : Screw type terminal block for Type 1, Bolt terminal for Type 2 (M8, M10 etc.... ) and terminals are protected against corrosion

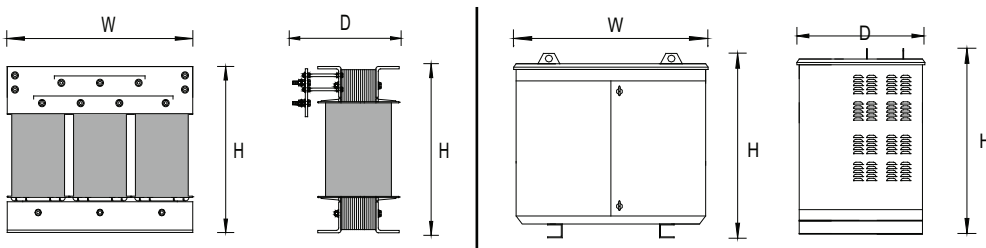

Standard Voltages :

Primary : 6-600-500-480-460-440-415-400-380-320-280-250-240-230-220-208-200-690-60V

Secondary : 1-100690-660-600-500-480-440-415-400-380-240-230-220-200-120-10V

Open Type IP00-

Model. No.	Power (KVA)	Overall Dimensions (mm)			Total Wt. Kg.
		(H)	(W)	(D)	
IT50-3	0.05	110	120	60	1.6
IT100-3	0.1	130	150	70	3.2
IT1-3K	1	225	240	140	14.2
IT5-3K	5	265	300	140	31.8
IT10-3K	10	370	360	220	69.0
IT15-3K	15	435	420	230	83.4
IT20-3K	20	360	420	285	89.3
IT25-3K	25	420	480	310	108.0
IT30-3K	30	420	480	320	116.5
IT40-3K	40	420	480	330	124.5
IT50-3K	50	420	480	325	194.2
IT100-3K	100	510	600	420	303.2
IT150-3K	150	770	900	570	510.0
IT200-3K	200	770	900	580	554.0
IT300-3K	300	880	1030	560	741.0
IT500-3K	500	990	1160	640	1010.0

Enclosure Type IP44-, IP42-, IP23-, IP55-, IP56-

Model. No.	Power (KVA)	Overall Dimensions (mm)			Total Wt. Kg.
		(H)	(W)	(D)	
IT1-3KW	1	500	325	250	21.8
IT5-3KE	5	500	480	330	46.8
IT10-3KE	10	560	540	390	89.0
IT15-3KE	15	725	590	490	119.0
IT20-3KE	20	835	690	540	147.0
IT25-3KE	25	825	690	540	157.0
IT30-3KE	30	825	690	540	165.5
IT40-3KE	40	825	690	540	173.5
IT50-3KE	50	825	690	540	243.2
IT100-3KE	100	510	600	420	303.2
IT150-3KE	150	1300	1220	890	608.0
IT200-3KE	200	1300	1220	890	680.0
IT300-3KE	300	1350	1250	990	1050.0
IT500-3KE	500	1610	1600	1050	1180.0
IT1000-3KE	1000	1860	1700	1200	2800.0
IT1500-3KE	1500	1970	1850	1250	3316.0
IT2000-3KE	2000	2000	2120	1800	3800.0
IT2500-3KE	2500	2100	2200	1900	4100.0

### Vector Diagrams & Symbols of the Transformer

Suffix 'W' for Wall enclosure and 'E' for floor enclosure.

